

## Root Barrier C3 Installation Guidelines

### JOINING PIECES OF ROOT BARRIER C3 TO FIT THE AREA YOU REQUIRE

Root Barrier C3 membrane comes in standard rolls (1.00, 1.50, 2.00, 3.00 and 4.00m x 25.00m plus 1.00 and 2.00m x 50.00m. ). Therefore, it may be necessary to cut and join to achieve the shape you require.

Place the rolls of membrane adjacent to each other and overlap each one to make the join, or cut it into required size pieces (if applicable). These will need to be joined together, side-by-side with tape and glue.



Minimum 500mm overlap on each joint

### ROOT BARRIER C3 OVERLAPS

Note: The bitumen based Root Barrier Tape needs to be at least 5°C before applying. If the tape does not adhere tightly to the root barrier membrane, carefully heat the surface of the tape with a blow lamp until it is evenly shiny (but not so hot that it smokes or curls excessively).

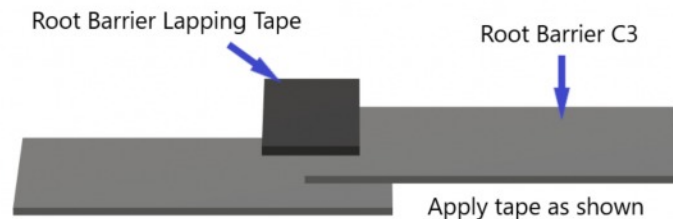

### INSTALLATION

Place the Root Barrier C3 membrane in the hole up to ground level at the sides and leave at least 100mm along the ground. Lay 100mm of sand (or more as may be required to fully protect the membrane from any damage) on top of the membrane and place boards against the sides to stop it falling back, being dragged down or damaged whilst back-filling.

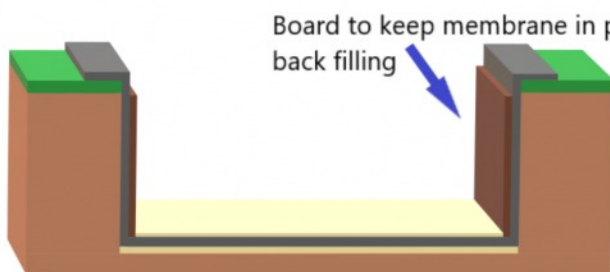

Root Barrier C3 with sand above and below

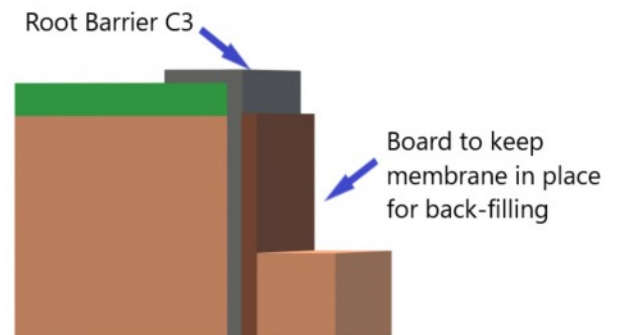

Note: The above information is of an illustrative nature only for your independent appraisal. Hy-Tex (UK) Limited do not provide a design service, so all information is provided in good faith, but without warranty (express or implied)

Application Categories: Landscaping and Weed Control, Tree Protection

## Root Barrier C3 Installation Guidelines

### SECURING ROOT BARRIER C3 TO A WALL

These are two options for securing Root Barrier C3 to a wall -

#### OPTION A

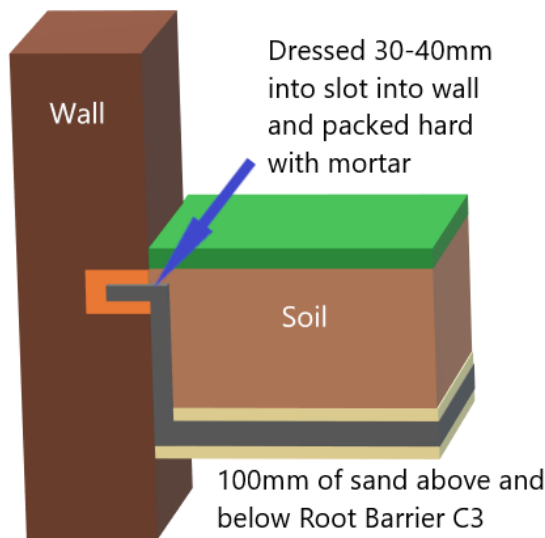

#### OPTION B

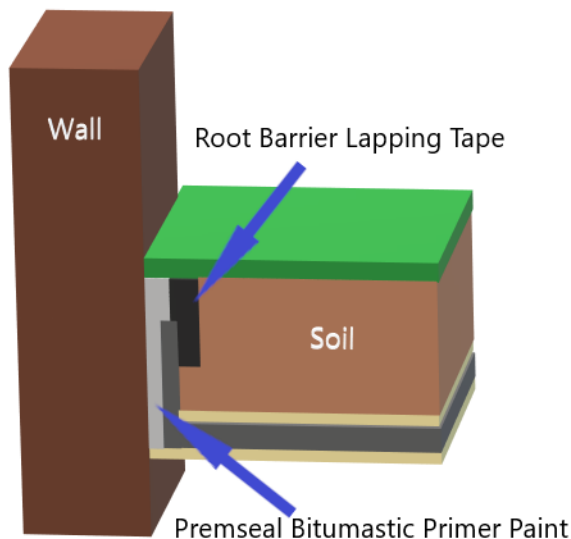

Note: The above information is of an illustrative nature only for your independent appraisal. Hy-Tex (UK) Limited do not provide a design service, so all information is provided in good faith, but without warranty (express or implied)

Application Categories: Landscaping and Weed Control, Tree Protection

## Root Barrier C3 Installation Guidelines

### INTERSECTING UNDERGROUND SERVICES

Cut a slit in the Root Barrier C3 and wrap it around the pipe

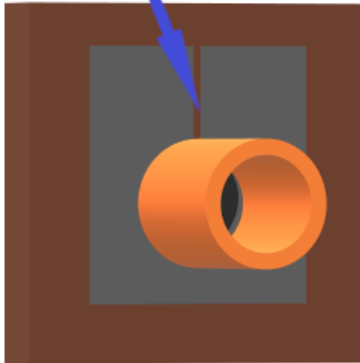

Use Root Barrier Lapping Tape to seal the slit

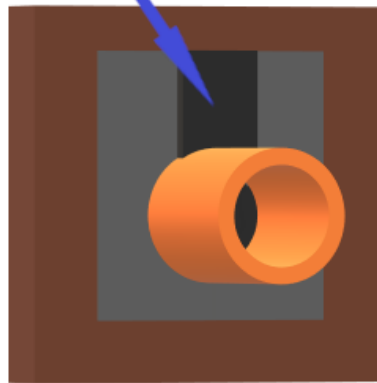

Apply Premseal bitumen primer on the Root Barrier C3 and around pipe (ensure pipe is clean)

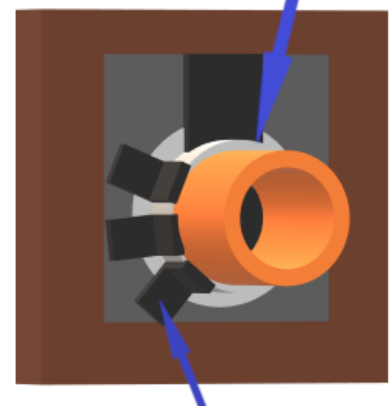

Cut strips of Root Barrier Tape (approx 400mm in length) and use to seal all the way around the pipe

Note: The above information is of an illustrative nature only for your independent appraisal. Hy-Tex (UK) Limited do not provide a design service, so all information is provided in good faith, but without warranty (express or implied)

Application Categories: Landscaping and Weed Control, Tree Protection

## Root Barrier C3 Installation Guidelines

### FINISHING TOP EDGE OF ROOT BARRIER C3

#### SOFT LANDSCAPE

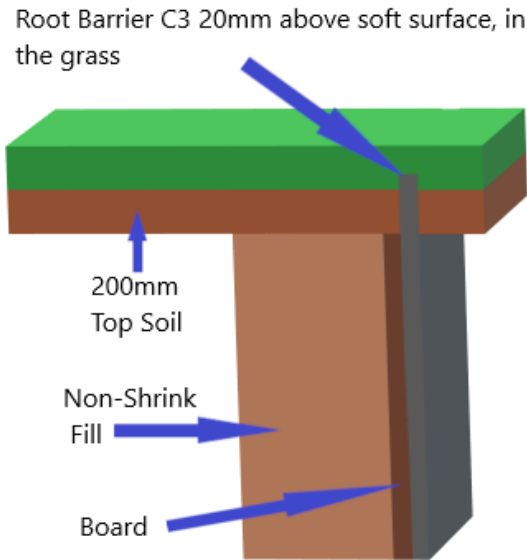

#### HARD LANDSCAPE

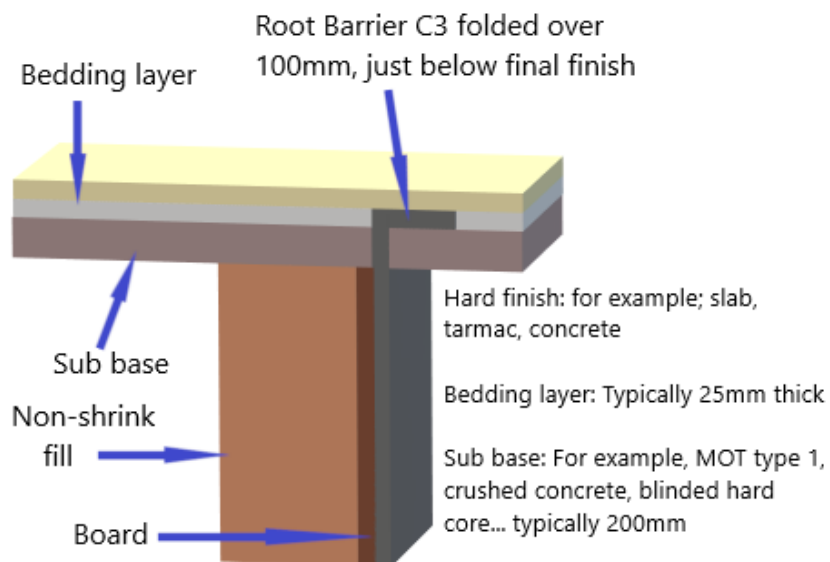

Note: The above information is of an illustrative nature only for your independent appraisal. Hy-Tex (UK) Limited do not provide a design service, so all information is provided in good faith, but without warranty (express or implied)

Application Categories: Landscaping and Weed Control, Tree Protection